

Balanced Armature Driver



Premium Audio

RAN-33860-000 & -B148

Single Tweeter

Features

- . Highly automated assembly for consistent volume production
- . Full traceability at unit level
- . Tuned for high frequency detail
- . Ideal for meeting Hi-Res Audio requirements
- . Small size suitable for hybrid and multiple BA earphones



Typical Performance at 1kHz

Impedance	14	Ohms
Sensitivity to 100mV	94	dB SPL
Sensitivity to 1mW	96	dB SPL
Max SPL ^a	108	dB SPL
THD at 94dB SPL	0.3	%
THD at 100dB SPL	0.5	%

a) SPL at 10% THD

Testing Condition

using 100mV rms drive signal

- 711 Hi-RES GRAS 403
- THD

Frequency Response and THD

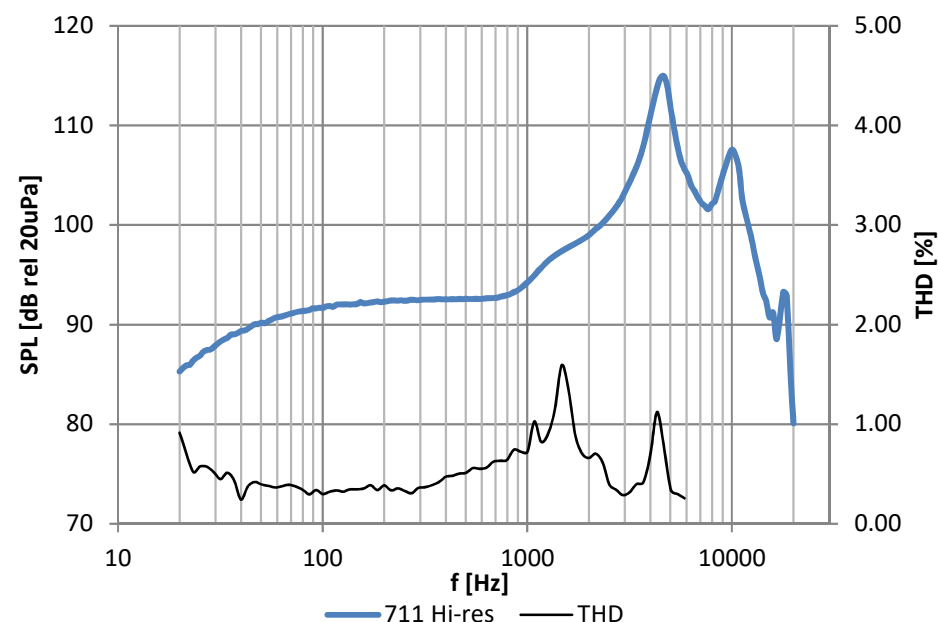

Balanced Armature Driver

RAN-33860-000 & -B148

Single Tweeter



Premium Audio

Impedance and Saturation SPL

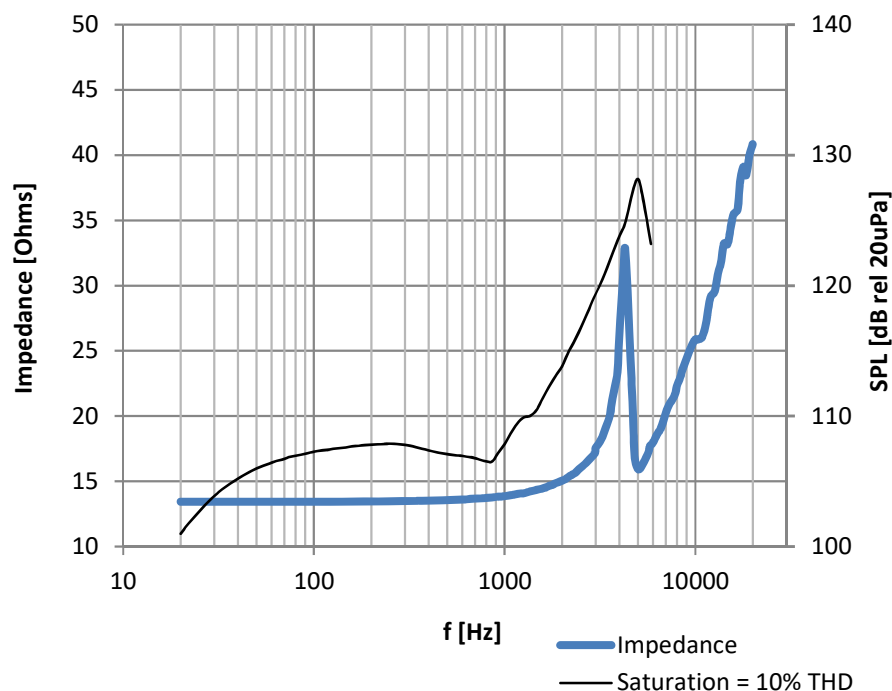

Outline Drawing

mm (inches)

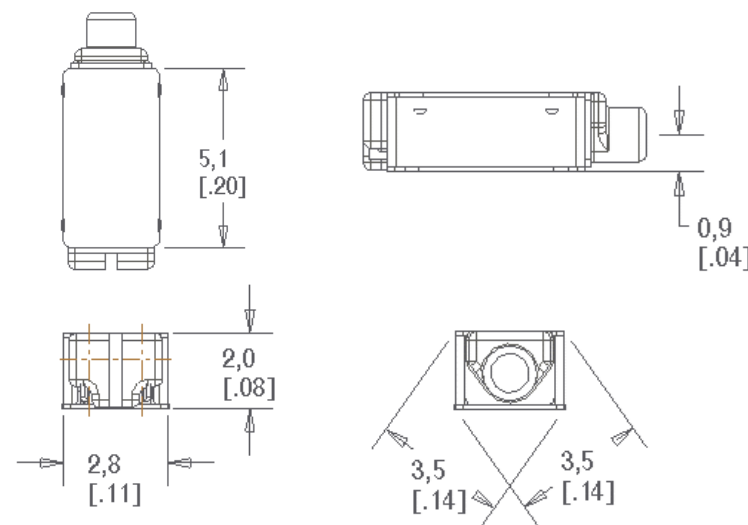

Notes

- Ask about custom assembly options (lead wires, subassemblies, etc.)
- To prevent heat damage, follow soldering guidelines in application note AN13 (knowles.com)
- Measurement data for reference only. Refer to model specification for full dimensions and performance.